

A big step forward

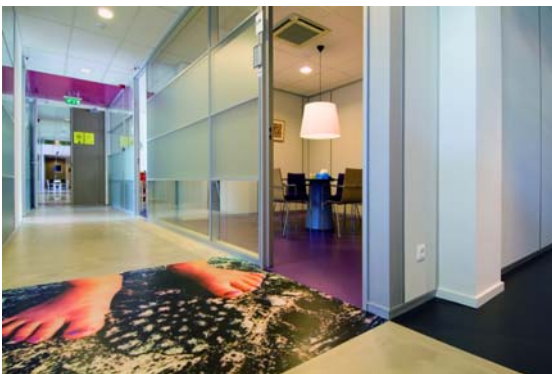

It is the Youth Welfare Bureau's duty to offer care to children and their parents. Their offices provide answers to questions concerning growing children and upbringing. Young and old should feel welcome, safe and secure during a visit.



Due to a number of mergers and changes, the Youth Welfare Bureau has no longer been able to meet its objectives. Part of the plan to resolve this situation was to redecorate the office on the Neherkade, in addition to restyling the headquarters in The Hague. The fact that children and parents are central to the Youth Welfare Bureau, was the main factor in the development of the new [interior](#). The interior should create a more accessible and open atmosphere. Architect Bureau 360 has developed an interior that meets all the requirements.



The Youth Welfare Bureau classifies its clients into several age groups. In the interior, this distinction is marked by colours and photographs that were used in the floors and on the walls. The feet in the photographs indicate the age group involved. [Bolidtop® Print](#) is a flooring system that seamlessly incorporates pictures in a synthetic floor finish. [Bolidtop® FiftyFifty](#) is one of the flooring systems that has been used in combination with Bolidtop® Print. The former system is characterized by the use of two contrasting colours in the synthetic finish. This produces a lively and three-dimensional effect.